

CATALOGO GENERALE - GENERAL CATALOGUE

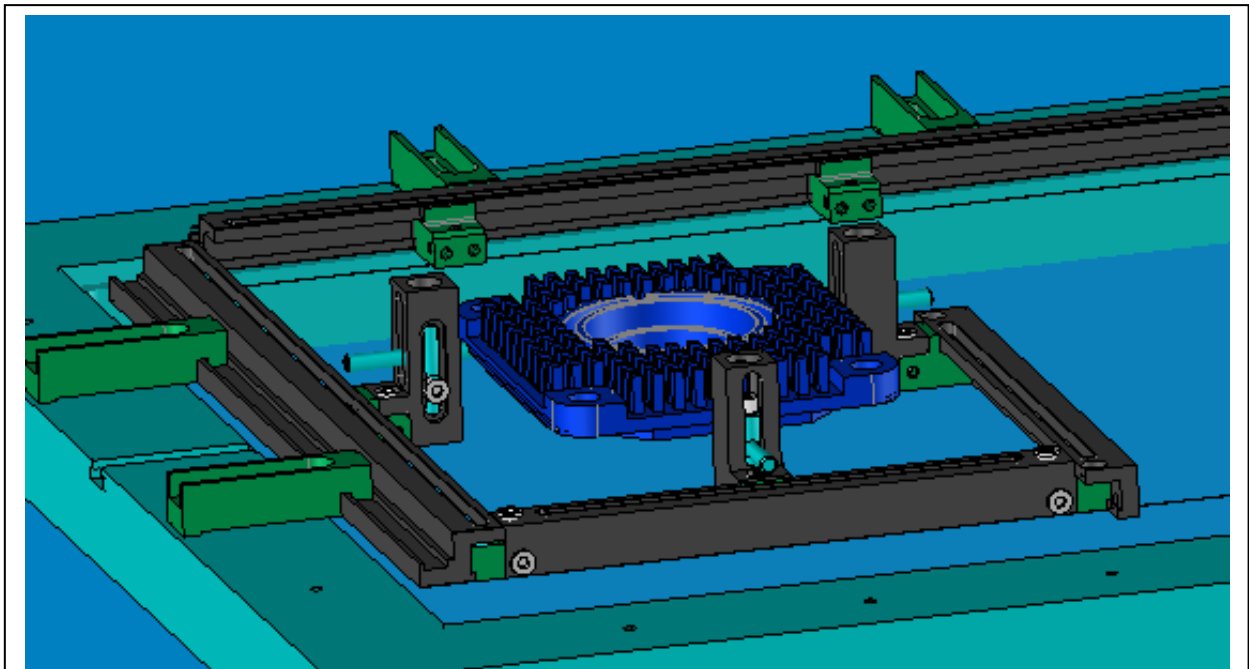

1.ELEMENTI BASE LINEARE CORNICE (2001xxx)

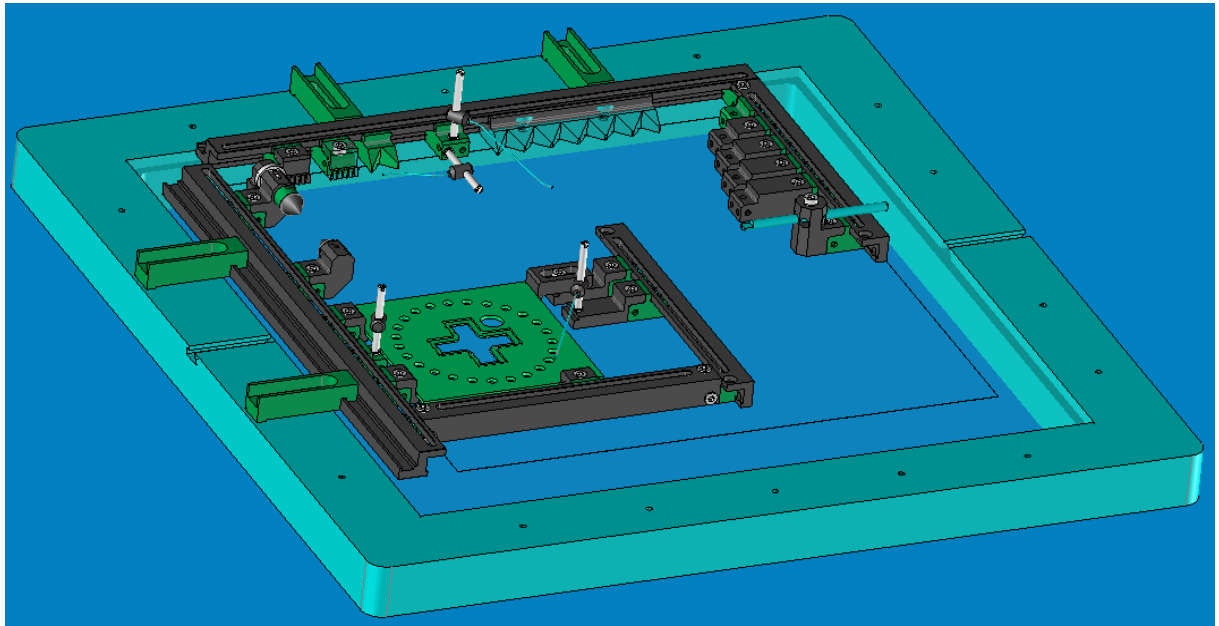
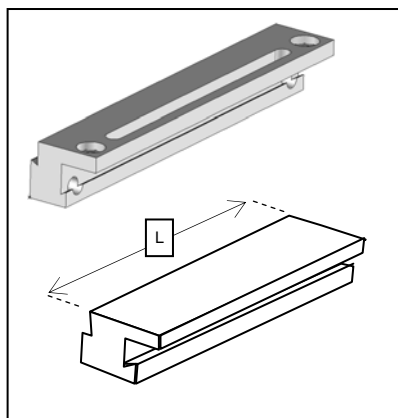

1.FRAME BASE (2001xxx)

Code	Descrizione	Description
2001110	Profilo esterno lunghezza 100mm	Linear Frame length 100mm
2001115	Profilo esterno lunghezza 150mm	Linear Frame length 150mm
2001120	Profilo esterno lunghezza 200mm	Linear Frame length 200mm
2001125	Profilo esterno lunghezza 250mm	Linear Frame length 250mm
2001130	Profilo esterno lunghezza 300mm	Linear Frame length 300mm
2001140	Profilo esterno lunghezza 400mm	Linear Frame length 400mm

2.ELEMENTI CONNESSIONE ED ADATTATORI (2002xxx)

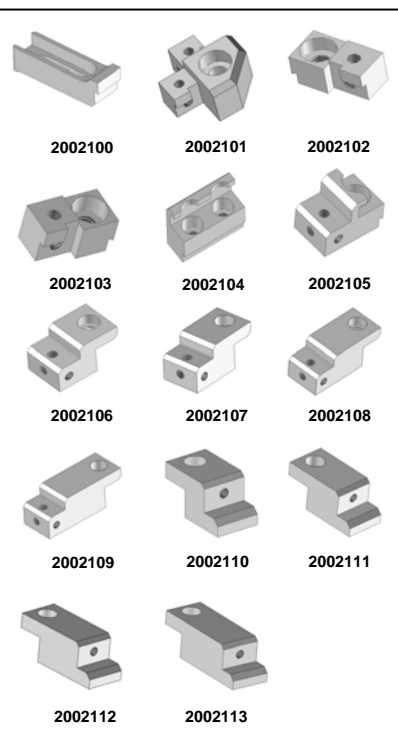

2.CONNECTION ELEMENTS AND ADAPTERS (2002xx)

Code	Descrizione	Description
2002100	Elemento Fissaggio Base Lineare	Element to lock the Linear Frame
2002101	Elemento Connessione Angolare	Linear Frame Base Corner Joint Element
2002102	Giunto lato sinistro Base Lineare Cornice	Left edge Joint Element
2002103	Giunto lato destro Base Lineare Cornice	Right edge Joint Element
2002104	Giunto Centrale Base Lineare Cornice	Central Joint Element
2002105	Elemento di Connessione Standard	Standard Base Fixing Block
2002106	Modulo prolunga lunghezza 15mm	Extension Base with 15mm length
2002107	Modulo prolunga lunghezza 20mm	Extension Base with 20mm length
2002108	Modulo prolunga lunghezza 25mm	Extension Base with 25mm length
2002109	Modulo prolunga lunghezza 30mm	Extension Base with 30mm length
2002110	Modulo prolunga verticale 10mm	Extension Base 10mm higher
2002111	Modulo prolunga verticale 15mm	Extension Base 15mm higher
2002112	Modulo prolunga verticale 20mm	Extension Base 20mm higher
2002113	Modulo prolunga verticale 25mm	Extension Base 25mm higher

3.ELEMENTI TERMINALI (2003xxx)

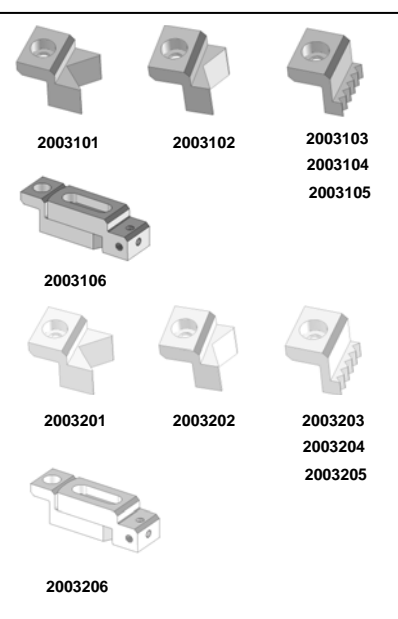

3.TOP ELEMENTS (1003xxx)

Code	Descrizione	Description
2003101	Appoggio a V di 90°	Block with single V shape 90° degree
2003102	Appoggio a V di 120°	Block with single V shape 120° degree
2003103	Appoggio piano V multiple lungo 15mm	Fixing Block with multiple V shape length 15mm
2003104	Appoggio piano V multiple lungo 45mm	Fixing Block with multiple V shape length 45mm
2003105	Appoggio piano V multiple lungo 90mm	Fixing Block with multiple V shape length 90mm
2003106	Prolunga asolata regolabile	Fixing Block with Upper Base adjustable position
2003201	appoggio a V di 90° Plexiglas	Block with single V shape 90° degree Plexiglas
2003202	appoggio a V di 120° Plexiglas	Block with single V shape 120° degree Plexiglas
2003203	appoggio piano V multiple lungo 15mm Plexiglas	Fixing Block with multiple V shape length 15mm Plexiglas
2003204	appoggio piano V multiple lungo 45mm Plexiglas	Fixing Block with multiple V shape length 45mm Plexiglas
2003205	appoggio piano V multiple lungo 90mm Plexiglas	Fixing Block with multiple V shape length 90mm Plexiglas
2003206	prolunga asolata regolabile Plexiglas	Fixing Block with Upper Base adjustable position Plexiglas

4.ELEMENTI RITENZIONE E PRESA (2004xxx)

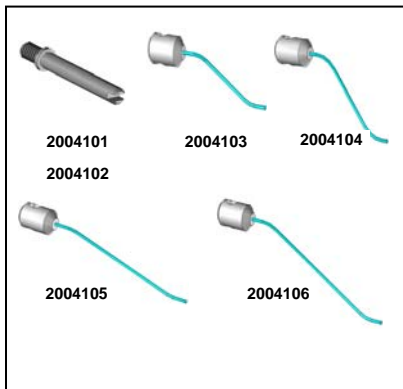

Code	Descrizione	Description
2004101	Asta per molla lunghezza 25mm	Spring Pin length 25mm
2004102	Asta per molla lunghezza 50mm	Spring Pin length 50mm
2004103	Molla L= 40x10mm	Spring L = 40x10
2004104	Molla L= 40x20mm	Spring L = 40x20
2004105	Molla L= 60x10mm	Spring L = 60x10
2004106	Molla L= 60x20mm	Spring L = 60x20

4.CLAMPING ELEMENTS (1004xxx)

5.ELEMENTI POSIZIONAMENTO E PRESA (2005xxx)

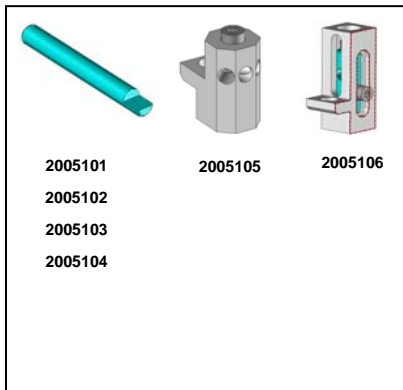

Code	Descrizione	Description
2005101	Perno lunghezza 40mm	Pin length 40mm
2005102	Perno lunghezza 60mm	Pin length 60mm
2005103	Perno lunghezza 80mm	Pin length 80mm
2005104	Perno lunghezza 100mm	Pin length 100mm
2005105	Torretta Perno con 3 posizioni fisse	Block with 3 fix Pin positions
2005106	Torretta Perno regolabile Altezza	Block with Adjustable Higher Pin Position

5.CLAMPING ELEMENTS (1005xxx)

6.ELEMENTI POSIZIONAMENTO E PRESA (2006xxx)

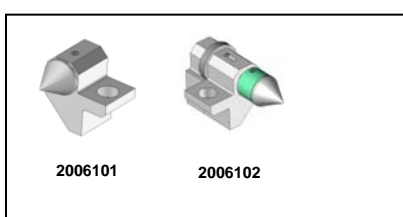

Code	Descrizione	Description
2006101	Supporto fisso	Block with fix Stud Terminal position
2006102	Supporto regolabile	Block with adjustable Stud Terminal position

6.CLAMPING ELEMENTS (1006xxx)

7.FISSAGGIO ELEMENTI CON TERMINALE CODOLO (10014xx)



Code	Descrizione	Description
1005101	Puntale 90°	Center 90 degree Pull Stud 12.5 diameter
1005102	Puntale 60°	Center 60 degree Pull Stud 12.5 diameter
1005103	Appoggio PIANO	Flat Pull Stud 12.5 Diameter
1005104	Appoggio VERTICI 90°	Stop and Support 90 Degree Pull Stud 12.5 Diameter
1005105	Appoggio VERTICI 180°	Stop and Support 180 Degree Pull Stud 12.5 Diameter
1005106	Appoggio con Sfera Flottante spianata	Floating Plane Pull Stud 12.5 Diameter
1005107	Appoggio con MAGNETE	Magnet Plane Pull Stud 12.5 Diameter
1005108	Appoggio a V 90°	V Block 90 Degree Pull Stud 12.5 Diameter
1005109	Appoggio a V 120°	V Block 120 Degree Pull Stud 12.5 Diameter
1005110	Riferimento Laterale con Spina 6mm regolabile	Side Pin Adjustable Reference Pull Stud 12.5 Diameter
1005111	Appoggio con FILETTO M8	M8 Tapped Element with Pull Stud 12.5 Diameter
1005112	Cilindro Lavorabile dedicato L=15mm	Customizable Pull Stud 12.5 Diameter L=15mm
1005113	Cilindro Lavorabile dedicato L=25mm	Customizable Pull Stud 12.5 Diameter L=25mm

1.40.SJS BLOCK Ax BxC (10014xx)

8.CHIAVI ESAGONALI STANDARD E SPECIALI (2008xxx)

8.SPECIAL HEXAGONAL KEY AND TOOL (2008xxx)



Code	Descrizione	Description
2008101	CHIAVE SPECIALE misura 3mm	Special Tool Key 3mm

Vi invitiamo a contattarci per avere ulteriori maggiori informazioni tecnico & commerciali sul nostro Sistema Fissaggio Modulare ALUKEEP.

Please feel You free to contact us for all kind of technical & commercial informations about ALUKEEP Modular Fixturing System.



Alukeep s.r.l.

Via Maestri del Lavoro n. 16
37059 Santa Maria di Zevio (VR)
ITALY

Phone: +39-045-6050205;

Fax: +39-045-6051645;

www.alukeep.com

Email: info@alukeep.com ;

Email: giorgio.morandin@alukeep.com

Email: dario.morandin@alukeep.com

Email: thomas.ambrosi@alukeep.com

Skype: giorgiomorandin

Skype: dariomorandin

Skype: thomasambrosi